



DESCRIZIONE TECNICA / TECHNICAL DESCRIPTION

N.B. GLI ELEMENTI COMPOSITIVI NON SONO VENDIBILI SINGOLARMENTE, MA SOLO IN UNA COMPOSIZIONE DI SEDUTE

STRUTTURA Legno imbottito con Poliuretano e Fiberfill. Inserto in acciaio finitura cromo lucido, Bronze Shadow, canna di fucile

STRUTTURA SEDUTA Legno imbottito con Poliuretano; cinghie elastiche intrecciate

CUSCINATURA SEDUTA Poliuretano e piumino

CUSCIN. SCHIENALE Piuma

RIVESTIMENTO Tessuto o pelle non removibile

PIEDI Legno tinto wengé

OPTIONAL 1 Cuscinatura schienale con inserto pelle Oblique A) e/o B)

OPTIONAL 2 Filetto Selleria inserto struttura

COFFEE TABLE Vedi modello Premiere

N.B. THE SECTIONAL ELEMENTS ARE NOT AVAILABLE AS SINGLE ELEMENT, BUT ONLY IN A SECTIONAL SOFA

FRAME Wood padded with Polyurethane and Fiberfill. Steel insert with polished chrome, gun-metal grey or Bronze Shadow finishing

SEAT FRAME Wood padded with Polyurethane and Fiberfill; interwoven elastic bands

SEAT CUSHIONS Polyurethane, down feather and Fiberfill

BACK CUSHIONS Feather

COVER Not removable fabric or leather

FEET Wood wengé stained

OPTIONAL 1 Back cushions with leather inlay Oblique A) and/or B)

OPTIONAL 2 Selleria piping on the frame insert

COFFEE TABLE See model Premiere



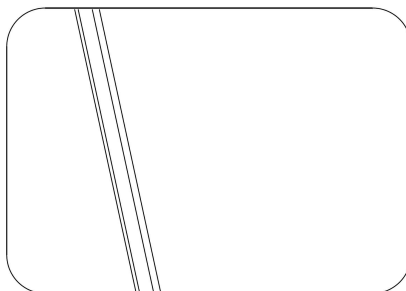

OPTIONAL OBLIQUE : INSERTO IN PELLE / LEATHER INLAY

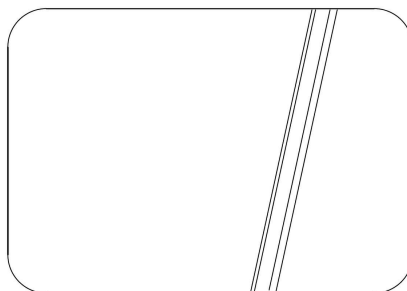

OPTIONAL OBLIQUE : INSERTO IN PELLE / LEATHER INLAY

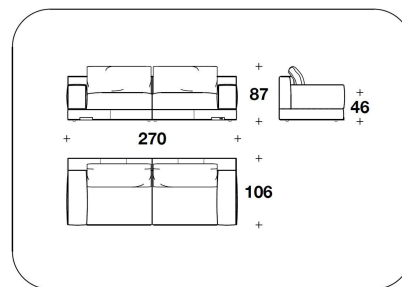

NHU (D3)
DIVANO 3 POSTI / 3 SEATER SOFA
270x106x87H. - H.S. 46cm
106 1/3x41 2/3x34 1/3H. - H.S. 18"

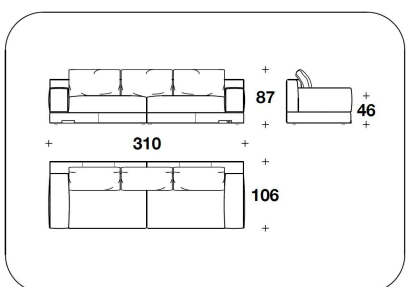

NHU (D4)
DIVANO 4 POSTI / 4 SEATER SOFA
310x106x87H. - H.S. 46cm
122x41 2/3x34 1/3H. - H.S. 18"

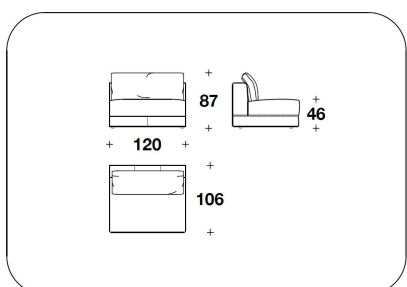

NHU (E1CN)
ELEMENTO CENTRALE 1 POSTO
GRANDE / 1 SEATER CENTRAL BIG
ELEMENT
120x106x87H. - H.S. 46cm
47 1/3x41 2/3x34 1/3H. - H.S. 18"

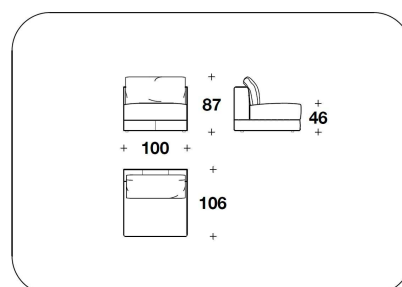

NHU (E1CNP)
ELEMENTO CENTRALE 1 POSTO / 1
SEATER CENTRAL ELEMENT
100x106x87H. - H.S. 46cm
39 1/3x41 2/3x34 1/3H. - H.S. 18"

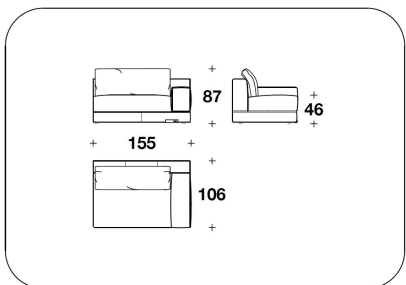

NHU (E1D) - NHU (E1S)
ELEMENTO 1 POSTO GRANDE
C/BRACCIOLO DX O SX / 1 SEATER
CENTRAL BIG ELEMENT W/RIGHT OR
LEFT ARM
155x106x87H. - H.S. 46cm
61x41 2/3x34 1/3H. - H.S. 18"

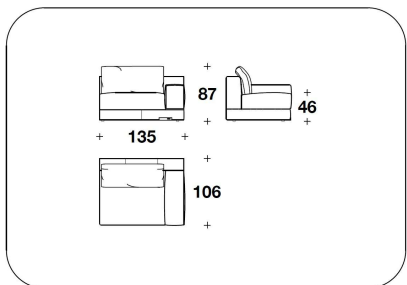

NHU (E1DP) NHU (E1SP)
ELEMENTO 1 POSTO C/BRACCIOLO
DX O SX / 1 SEATER ELEMENT
W/RIGHT OR LEFT ARM
135x106x87H. - H.S. 46cm
53x41 2/3x34 1/3H. - H.S. 18"

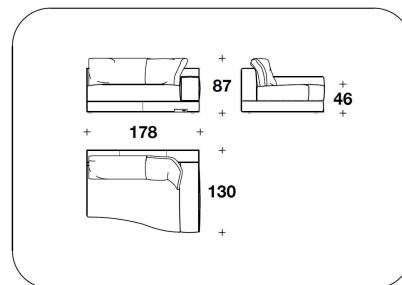

NHU (PED) - NHU (PES)
ELEMENTO PENISOLA / PENINSULA
ELEMENT
178x130x87H. - H.S. 46 cm
70x51 1/3x34 1/3H. - H.S. 18 "

Note